

Terminal prensado flange 90°

terminal sem solda

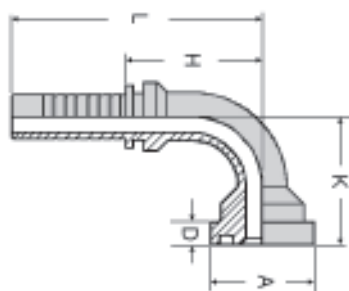

3000 psi (cód. 61)

Ø		Ø nominal flange	medidas					código para pedidos com mangueiras R01/R02/R08/R12/4SP/4SH
pol	traço		H	L	K	A	D	
1/2"	-8	-8	41	74	39	30,2	7	PF908-8
5/8"	-10	-8	49	85	46	30,2	7	PF908-10
5/8"	-10	-12	49	85	43	38,0	7	PF9012-10
3/4"	-12	-12	58	99	53	38,0	7	PF9012-12
3/4"	-12	-16	58	99	53	44,5	8,2	PF9016-12
1"	-16	-16	74	129	65	44,5	8,2	PF9016-16
1"	-16	-20	74	129	65	50,8	8,2	PF9020-16
1.1/4"	-20	-20	92	153	78	50,8	8,2	PF9020-20
1.1/4"	-20	-24	92	153	78	60,4	8,2	PF9024-20
1.1/2"	-24	-24	108	179	89	60,4	8,2	PF9024-24
2"	-32	-32	142	218	115	71,4	9,7	PF9032-32

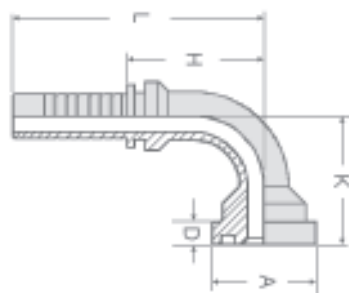

6000 psi (cód. 62)

Ø		Ø nominal flange	medidas					código para pedidos com mangueiras R01/R02/R08/R12/4SP/4SH
pol	traço		H	L	K	A	D	
1/2"	-8	-8	41	74	39	31,8	9	PFR908-8
5/8"	-10	-8	49	85	47	31,8	9	PFR908-10
5/8"	-10	-12	49	85	43	41,2	9	PFR9012-10
3/4"	-12	-12	58	99	53	41,2	9	PFR9012-12
3/4"	-12	-16	58	99	53	47,8	9,6	PFR9016-12
1"	-16	-16	74	129	65	47,8	9,6	PFR9016-16
1"	-16	-20	74	129	65	53,9	10,4	PFR9020-16
1.1/4"	-20	-20	92	153	78	53,9	10,4	PFR9020-20
1.1/4"	-20	-24	92	153	78	63,5	12,7	PFR9024-20
1.1/2"	-24	-24	108	179	89	63,5	12,7	PFR9024-24
2"	-32	-32	142	218	115	79,4	12,7	PFR9032-32

Obs.: O código para pedidos se refere somente ao pino, sem a capa